

Wire Wound Inductor with Magnetic shielding – SWI1008P

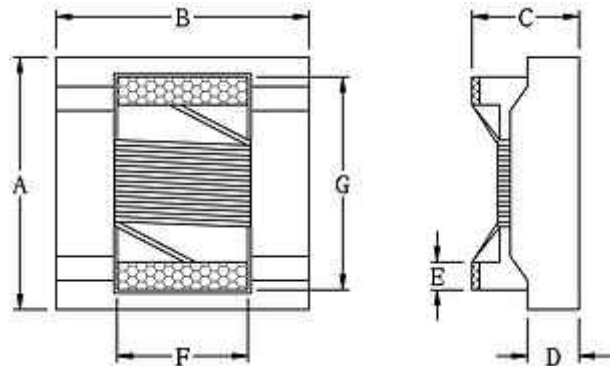
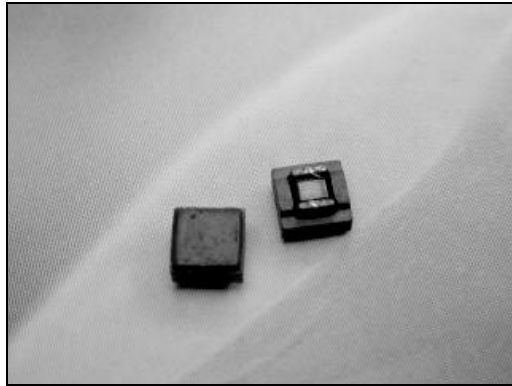

Features

- Excellent Solderability and resistance to soldering heat
- Wound chip inductor with magnetic shielding, which is suitable for high current applications such as notebook, electronic devices etc.
- High reliability and easy surface mount assembly

Dimensions

Part No.	A	B	C				
SWI1008P	3.6 ± 0.2	3.6 ± 0.2	2.5 ± 0.2	D	E	F	G
				1.6 ± 0.2	0.50 ± 0.1	2.0 ± 0.2	2.5 ± 0.1

Ordering Information

SWI 1008P – 4R7 M

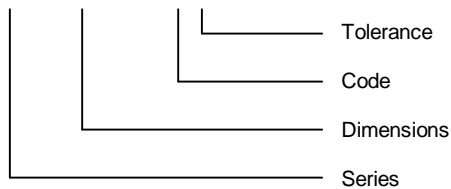

SIZE	SWI1008P
QTY/REEL	750pcs.

Characteristics

Tolerance: M = $\pm 20\%$, M tolerance is standard.

Part No.	Inductance (μH)	Q (min)	Test Frequency (KHz)	SRF Min. (MHz)	RDC Max. (Ω)	IDC Max. (mA)
SWI1008P-1R0M	1.0	35	100	344	0.05	1000
SWI1008P-1R5M	1.5	35	100	260	0.06	800
SWI1008P-1R8M	1.8	35	100	225	0.09	600
SWI1008P-2R7M	2.7	38	100	185	0.14	650
SWI1008P-3R9M	3.9	38	100	175	0.26	650
SWI1008P-4R7M	4.7	38	100	160	0.35	500
SWI1008P-5R6M	5.6	38	100	150	0.40	450
SWI1008P-6R8M	6.8	38	100	120	0.60	400
SWI1008P-100M	10	38	100	100	0.95	250
SWI1008P-150M	15	38	100	35	1.15	220
SWI1008P-220M	22	40	100	26	1.40	180
SWI1008P-330M	33	45	100	20	1.60	150
SWI1008P-390M	39	45	100	14	1.85	130
SWI1008P-470M	47	45	100	14	2.50	110
SWI1008P-680M	68	45	100	12	3.80	100
SWI1008P-820M	82	45	100	9.0	4.20	100
SWI1008P-101M	100	45	100	7.0	5.80	80
SWI1008P-121M	120	45	100	6.0	6.20	60
SWI1008P-151M	150	40	100	5.6	7.50	50
SWI1008P-221M	220	40	100	4.0	10.0	50
SWI1008P-331M	330	40	100	3.8	11.5	50
SWI1008P-471M	470	35	100	2.0	16.5	50
SWI1008P-561M	560	35	100	2.0	18.0	30
SWI1008P-681M	680	30	100	1.8	24.0	30
SWI1008P-821M	820	30	100	1.5	26.0	30
SWI1008P-102M	1000	30	100	1.3	30.0	30