

SMD Power Inductor – SSPH Series

SCHMID-M

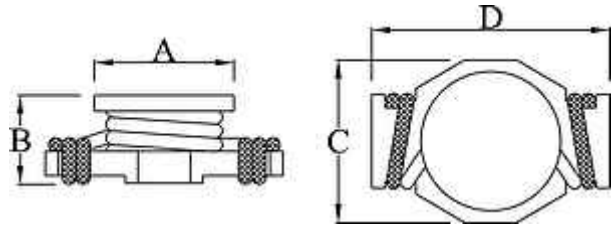
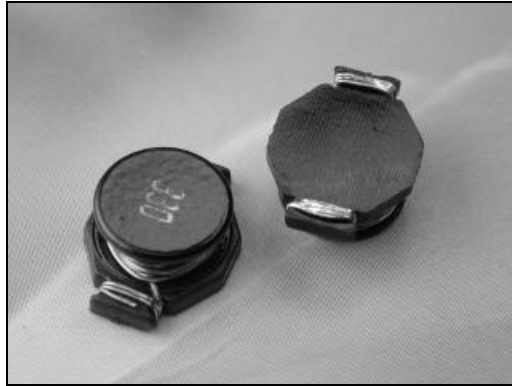

Features

- For high current, low voltage à DC/DC Converters
- Microprocessors
(esp. the latest generation of 3.3V products)
- High current rating, low DC resistance
- Reliable surface mounting with a large flat top and self-leaded design

Dimensions

Part No.	A	B	C	D
SSPH0504	4.8 ± 0.15	5.00 Max.	6.10 Max.	8.89 Max.
SSPH0804	8.6 Max.	6.35 Max.	9.91 Max.	13.21 Max.
SSPH1306	13.0 Max.	8.00 Max.	16.26 Max.	22.35 Max.

Ordering Information

SSPH 0504-4R7 M

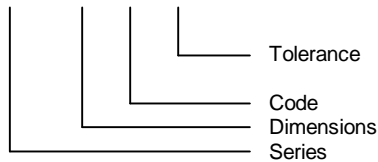

TYPE	SSPH0504	SSPH0804	SSPH1306
QTY/REEL	1000pcs.	750pcs.	250pcs.

Characteristics

Tolerance: M = ± 20%, M tolerance is standard.

Part No.	L (µH)	Test Frequency (KHz)	RDC Max.(Ω)	IDC Max.(A)
SSPH0504-R56M	0.56	100	0.010	7.70
SSPH0504-1R2M	1.20	100	0.017	5.30
SSPH0504-2R2M	2.20	100	0.035	3.50
SSPH0504-4R7M	4.70	100	0.054	2.60
SSPH0504-100M	10.0	100	0.111	1.90
SSPH0504-150M	15.0	100	0.170	1.50
SSPH0504-220M	22.0	100	0.250	1.20
SSPH0504-330M	33.0	100	0.350	0.99
SSPH0504-470M	47.0	100	0.470	0.87
SSPH0804-R33M	0.33	100	0.002	20.0
SSPH0804-R68M	0.68	100	0.005	13.0
SSPH0804-1R0M	1.00	100	0.006	11.0
SSPH0804-1R5M	1.50	100	0.008	9.00
SSPH0804-2R2M	2.20	100	0.011	7.80
SSPH0804-2R7M	2.70	100	0.012	7.00
SSPH0804-3R3M	3.30	100	0.014	6.40
SSPH0804-4R7M	4.70	100	0.018	5.40
SSPH1306-R78M	0.78	100	0.0026	30.0
SSPH1306-1R5M	1.50	100	0.004	25.0
SSPH1306-2R2M	2.20	100	0.0061	20.0
SSPH1306-3R3M	3.30	100	0.0086	17.0
SSPH1306-3R9M	3.90	100	0.010	15.0
SSPH1306-4R7M	4.70	100	0.014	13.0
SSPH1306-6R0M	6.00	100	0.017	12.0
SSPH1306-7R8M	7.80	100	0.018	11.0
SSPH1306-100M	10.0	100	0.026	10.0
SSPH1306-150M	15.0	100	0.032	8.00