

Axial Ferrite Bead – SRH Series

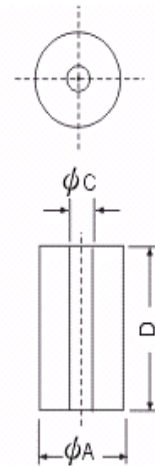

Features

- Employ High-Performance ferrites with superior frequency characteristic. Compact and high performance. Easy installation.
- Countermeasure against radiated emissions – full compliance with FCC

Ordering Information

SRH 11.0x5.0x25.0

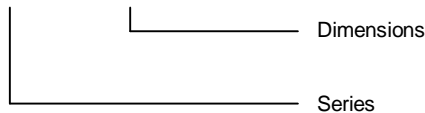

Characteristic

Part No.	A	C	D	Material	Impedance (Ω) min	
					25MHz	100MHz
SRH2.5x0.8x3.0	2.5 ± 0.15	0.8 ± 0.15	3.0 ± 0.2	K5A	20	30
SRH2.5x1.0x3.0	2.5 ± 0.15	1.0 ± 0.15	3.0 ± 0.2	K5A	10	30
SRH3.5x0.9x6.0	3.5 ± 0.15	0.9 ± 0.1	6.0 ± 0.3	K5A	50	75
SRH3.5x1.3x3.0	3.5 ± 0.15	1.3 ± 0.1	3.0 ± 0.2	K5A	10	20
SRH3.5x1.0x5.0	3.5 ± 0.15	1.0 ± 0.15	5.0 ± 0.3	K5A	20	45
SRH4.0x2.0x15.0	4.0 ± 0.2	2.0 ± 0.15	15.0 ± 0.5	K5	50	80
SRH4.0x2.0x25.0	4.0 ± 0.2	2.0 ± 0.15	25.0 ± 0.3	K5A	90	120
SRH4.0x2.2x6.0	4.0 ± 0.2	2.2 ± 0.15	6.0 ± 0.3	K5A	20	40
SRH4.0x2.2x25.0	4.0 ± 0.2	2.2 ± 0.15	25.0 ± 0.6	K5A	90	120
SRH4.1x2.0x6.0	4.1 ± 0.2	2.0 ± 0.15	6.0 ± 0.3	K5A	20	30
SRH4.2x2.0x15.0(R)	4.2 ± 0.2	2.0 ± 0.15	15.0 ± 0.4	C3B	45	90
SRH4.2x2.0x15.0(C)	4.2 ± 0.2	2.0 ± 0.15	15.0 ± 0.4	C3B	45	90
SRH4.5x1.5x7.0	4.5 ± 0.2	1.5 ± 0.1	7.0 ± 0.3	K5	40	80
SRH4.5x2.5x7.0	4.5 ± 0.2	2.5 ± 0.15	7.0 ± 0.3	K5A	35	65
SRH4.9x2.0x36.0	4.9 ± 0.2	2.0 ± 0.15	36.0 ± 0.8	K6	140	200
SRH5.08x2.29x10	5.08 ± 0.2	2.29 ± 0.15	10.0 ± 0.4	K5A	40	65
SRH6.35x2.95x25.4	6.35 ± 0.2	2.95 ± 0.15	25.4 ± 0.6	K5A	108	200
SRH6.35x3.2x12.7	6.35 ± 0.2	3.2 ± 0.2	12.7 ± 0.4	K5A	55	102
SRH6.5x4.0x10.0	6.5 ± 0.2	4.0 ± 0.2	10.0 ± 0.4	K5A	20	40
SRH6.5x4.5x10.0	6.5 ± 0.2	4.5 ± 0.2	10.0 ± 0.4	K5A	15	35
SRH7.52x2.39x7.54	7.52 ± 0.2	2.39 ± 0.15	7.54 ± 0.3	K5A	30	60
SRH7.8x4.0x13.0	7.8 ± 0.2	4.0 ± 0.2	13.0 ± 0.4	K5A	45	80
SRH7.8x5.0x12.5	7.8 ± 0.2	5.0 ± 0.25	12.5 ± 0.4	K5A	30	60
SRH8.0x5.3x15.0	8.0 ± 0.2	5.3 ± 0.25	15.0 ± 0.4	K5A	40	80
SRH9.0x5.0x16.0	9.0 ± 0.3	5.0 ± 0.25	16.0 ± 0.4	K5A	50	80
SRH9.05x4.7x16.2	9.05 ± 0.3	4.7 ± 0.2	16.2 ± 0.4	K5A	60	110
SRH9.5x4.8x14.5	9.5 ± 0.3	4.8 ± 0.2	14.5 ± 0.4	K5A	53	75
SRH9.5x5.0x14.5	9.5 ± 0.3	5.0 ± 0.25	14.5 ± 0.4	K5A	50	100
SRH9.5x5.2x9.5	9.5 ± 0.3	5.2 ± 0.25	9.5 ± 0.4	K5A	35	65
SRH9.65x5.02x10.4	9.65 ± 0.3	5.02 ± 0.25	10.4 ± 0.4	K5A	30	60
SRH9.7x3.8x10.2	9.7 ± 0.3	3.8 ± 0.2	10.2 ± 0.4	K5A	60	100
SRH9.8x6.3x15.7	9.8 ± 0.3	6.3 ± 0.3	15.7 ± 0.4	K5A	45	65
SRH10.0x5.0x25.0	10.0 ± 0.3	5.0 ± 0.25	25.0 ± 0.6	K5A	125	160



Part No.	A	C	D	Material	Impedance (Ω) min	
					25MHz	100MHz
SRH10.0x5.5x2.5	10.0 ± 0.3	5.5 ± 0.25	2.5 ± 0.6	K5A	90	160
SRH10.0x6.0x14.0	10.0 ± 0.3	6.0 ± 0.3	14.0 ± 0.4	K5A	35	75
SRH10.0x6.15x6.2	10.0 ± 0.3	6.15 ± 0.3	6.2 ± 0.3	K5A	45	85
SRH10.0x7.0x10.0	10.0 ± 0.3	7.0 ± 0.3	10.0 ± 0.4	K5A	20	40
SRH10.5x5.5x20.0	10.5 ± 0.3	5.5 ± 0.25	20.0 ± 0.5	K5A	65	120
SRH11.0x5.0x25.0	11.0 ± 0.3	5.0 ± 0.25	25.0 ± 0.6	K5A	115	180
SRH11.3x5.95x12.0	11.3 ± 0.3	5.95 ± 0.25	12.0 ± 0.4	K5A	40	70
SRH11.86x7.4x15.0	11.86 ± 0.3	7.4 ± 0.3	15.0 ± 0.4	K5A	35	75
SRH12.0x4.0x23.0	12.0 ± 0.3	4.0 ± 0.2	23.0 ± 0.5	K5A	160	230
SRH12.0x5.6x20.0	12.0 ± 0.3	5.6 ± 0.25	20.0 ± 0.5	K5A	100	200
SRH12.0x8.0x13.0	12.0 ± 0.3	8.0 ± 0.3	13.0 ± 0.4	K5A	35	75
SRH12.0x8.5x15.0	12.0 ± 0.3	8.5 ± 0.3	15.0 ± 0.4	K5A	30	50
SRH12.3x5.0x12.7	12.3 ± 0.3	5.0 ± 0.25	12.7 ± 0.4	K5A	60	120
SRH12.7x6.0x21.7	12.7 ± 0.3	6.0 ± 0.3	21.7 ± 0.5	K6	85	135
SRH12.7x7.9x12.7	12.7 ± 0.3	7.9 ± 0.3	12.7 ± 0.4	K5A	30	60
SRH13.0x7.0x15.0	13.0 ± 0.3	7.0 ± 0.3	15.0 ± 0.4	P3	75	140
SRH14.0x6.8x15.0	14.0 ± 0.4	6.8 ± 0.3	15.0 ± 0.4	K5	65	120
SRH14.0x7.8x15.0	14.0 ± 0.4	7.8 ± 0.3	15.0 ± 0.4	K5A	35	70
SRH14.2x4.5x28.5	14.2 ± 0.4	4.5 ± 0.2	28.5 ± 0.6	K5A	160	300
SRH14.2x6.35x28.5	14.2 ± 0.4	6.35 ± 0.3	28.5 ± 0.6	K5A	100	190
SRH14.2x6.35x36.0	14.2 ± 0.4	6.35 ± 0.3	36.0 ± 0.8	K5A	150	280
SRH14.2x7.2x28.5	14.2 ± 0.4	7.2 ± 0.3	28.5 ± 0.6	K5A	130	210
SRH14.2x7.0x28.5	14.2 ± 0.4	7.0 ± 0.3	28.5 ± 0.6	K5A	100	120
SRH14.2x8.0x23.5	14.2 ± 0.4	8.0 ± 0.3	23.5 ± 0.5	K5A	65	135
SRH14.2x8.0x28.5	14.2 ± 0.4	8.0 ± 0.3	28.5 ± 0.6	K5A	60	150
SRH14.2x9.15x28.5	14.2 ± 0.4	9.15 ± 0.3	28.5 ± 0.6	K5A	100	170
SRH14.2x9.0x15.0	14.2 ± 0.4	9.0 ± 0.3	15.0 ± 0.4	K5A	50	100
SRH14.3x6.35x23.3	14.3 ± 0.4	6.35 ± 0.3	23.3 ± 0.5	K5A	100	180
SRH14.3x9.15x28.5	14.3 ± 0.4	9.15 ± 0.3	28.5 ± 0.6	K5A	75	120
SRH14.3x9.0x28.5	14.3 ± 0.4	9.0 ± 0.3	28.5 ± 0.6	K5A	75	120
SRH15.7x10.5x28.5	15.7 ± 0.4	10.5 ± 0.3	28.5 ± 0.6	K5A	60	100
SRH15.7x7.3x28.5	15.7 ± 0.4	7.3 ± 0.3	28.5 ± 0.6	K5A	90	180
SRH15.7x7.5x28.5	15.7 ± 0.4	7.5 ± 0.3	28.5 ± 0.6	K5A	90	180
SRH15.88x8.0x28.5	15.88 ± 0.4	8.0 ± 0.3	28.5 ± 0.6	K5A	100	160
SRH16.0x4.3x17.5	16.0 ± 0.4	4.3 ± 0.3	17.5 ± 0.4	K5A	100	185
SRH16.0x8.0x16.0	16.0 ± 0.4	8.0 ± 0.3	16.0 ± 0.4	K5A	55	110
SRH16.0x9.0x17.0	16.0 ± 0.4	9.0 ± 0.3	17.0 ± 0.4	K5A	50	80
SRH16.0x9.0x28.0	16.0 ± 0.4	9.0 ± 0.3	28.0 ± 0.6	K5A	80	150
SRH17.07x8.76x25.4	17.07 ± 0.4	8.76 ± 0.3	25.4 ± 0.6	K5A	90	130
SRH17.2x7.0x28.5	17.2 ± 0.4	7.0 ± 0.3	28.5 ± 0.6	K5A	140	230
SRH17.5x7.0x25.4	17.5 ± 0.4	7.0 ± 0.3	25.4 ± 0.6	P2M	110	200
SRH17.5x9.5x28.5	17.5 ± 0.4	9.5 ± 0.3	28.5 ± 0.6	K5A	85	145
SRH17.5x9.5x35.0	17.5 ± 0.4	9.5 ± 1.4	35.0 ± 0.8	K5A	120	200
SRH17.5x10.5x24.0	17.5 ± 0.4	10.5 ± 0.4	24.0 ± 0.6	K5A	85	130
SRH17.5x10.5x28.5	17.5 ± 0.4	10.5 ± 0.4	28.5 ± 0.6	K5A	90	150
SRH17.5x10.0x28.5	17.5 ± 0.4	10.0 ± 0.4	28.5 ± 0.6	K5A	100	240
SRH17.5x11.0x28.5	17.5 ± 0.4	11.0 ± 0.4	28.5 ± 0.6	K5A	80	130
SRH18.0x10.5x18.0	18.0 ± 0.5	10.5 ± 0.4	18.0 ± 0.6	K5A	45	90
SRH18.2x9.7x28.2	18.2 ± 0.5	9.7 ± 0.3	28.2 ± 0.6	K5A	133	250
SRH18.7x10.2x28.5	18.7 ± 0.5	10.2 ± 0.4	28.5 ± 0.6	K5A	70	130
SRH19.0x13.0x29.0	19.0 ± 0.5	13.0 ± 0.4	29.0 ± 0.6	K5A	60	110
SRH19.2x11.6x28.6	19.2 ± 0.5	11.6 ± 0.4	28.6 ± 0.6	K5A	76	118
SRH20.7x12.0x28.5	20.7 ± 0.6	12.0 ± 0.4	28.5 ± 0.6	K5A	85	160
SRH25.9x12.3x29.0	25.9 ± 0.6	12.3 ± 0.4	29.0 ± 0.6	K5A	90	180
SRH25.9x0.6x29.0	25.9 ± 0.6	0.6 ± 0.4	29.0 ± 0.6	K5A	120	240
SRH26.0x13.0x28.5	26.0 ± 0.6	13.0 ± 0.4	28.5 ± 0.6	K5A	116	180
SRH26.0x14.0x28.5	26.0 ± 0.6	14.0 ± 0.4	28.5 ± 0.6	K5A	90	180
SRH28.0x14.0x28.0	28.0 ± 0.6	14.0 ± 0.4	28.0 ± 0.6	K5A	110	180
SRH28.0x16.0x28.5	28.0 ± 0.6	16.0 ± 0.4	28.5 ± 0.6	K5A	110	220