

SCHMID-M

SMD current-compensated choke - SCC – SMD series

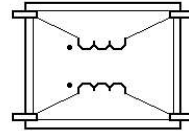
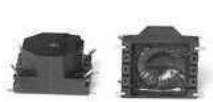

Recommended soldering areas

Features

- Ideal for RFI suppression of Appliances, switch sources and machines
- High permeability ferrite toroids with two symmetrical windings
- Easy mounting with the 4 pins housing
- Excellent soldering ability and heat resistance
- High reliability

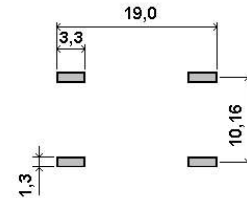
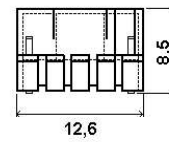
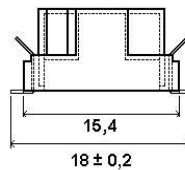

Technical data

Climatic category	40/125/21
Nominal voltage	250V , 50Hz
Testing voltage	1500V , 50Hz , 2sec.
Inductance tolerance	+ - 30%
Overtemperature of the windings	< 55°C
Insulating resistance	50 MΩ, 500Vdc

Standard parts

	Inductance (mH)	DC Resistance (mOhm)	Rated Current (A)
SCC-SMD - 332	3,3	240	1,0
SCC-SMD - 103	10,0	600	0,6
SCC-SMD - 393	39,0	2900	0,3

Insertion loss of current compensated nanocrystalline choke

